

# Radiology

Issue 6 *focus*

**UAB** SCHOOL OF MEDICINE  
Knowledge that will change your world

## Molecular Imaging of Chemical Threats and Countermeasures

In August, a five-year, \$3.8M grant from the National Institute of Neurological Disorders and Stroke has been awarded to a research team including Kurt Zinn (University of Alabama at Birmingham), John Gerdes (Southern Research Institute), Chuck Thompson (University of Montana), and Henry VanBrocklin (University of California, San Francisco). The grant will be used to support research that investigates new chemical and imaging technologies to understand how poisonous organophosphates enter the brain and how antidotes and therapeutics can be used to reduce neurotoxic effects to organophosphate exposures. Organophosphates are chemicals that have been used for decades as pesticides but are also major components of chemical nerve agents that represent a continued threat to military personnel and citizens from terrorist groups and rogue nations. The investigation will draw from the researchers' collabora-

tive expertise to transform the toxic organo-

phosphates into safe, beneficial imaging technologies that lead to highly useful clinical tools and therapeutic inventions. Central to the award is the utilization of positron emission tomography (PET) imaging to evaluate organophosphate exposures and the efficacy of the therapeutics. PET imaging has been used widely in cancer diagnosis and to determine the progress of certain neurodegenerative diseases such as Parkinson's and Alzheimer's. However, this research is the first use of PET imaging to study toxic organophosphates. The researchers are hopeful that this PET imaging investigation will unveil important characteristics about brain susceptibility to toxic agents and guide drug development that halts or reverses the toxic effects following organophosphate exposures.

**Grant Number: 1U01NS092495-01**  
**Institute: National Institute Of Neurological Disorders And Stroke**

## Distinguished Investigator Award from AAR

Congratulations to Kurt R. Zinn, DVM, PhD as the named winner of the 2015 Distinguished Investigator Award by the Academy of Radiology Research (AAR). The Academy annually gives this award to celebrate and recognize the tremendous accomplishments in the field of academic research. As Vice Chair of Translational Research in the Department of Radiology at the UAB School of Medicine, Dr. Zinn has continued to make incredible contributions to the Radiology Department and the ever-growing field of translational science.

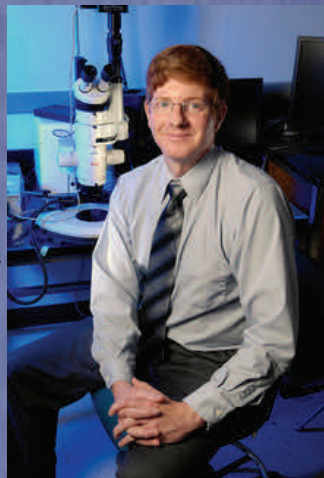

## 2015 Aunt Minnie Awards

UAB was named one of the 2015 Aunt Minnie Finalists for 'Best Radiologist Training Programs'. Additionally, as a prior Director of our Radiology Residency Program, and now Chair of the Radiology Department, Cheri L. Canon, MD, FACR was named one of the 2015 Aunt Minnie Finalists 'Most Effective Radiology Educator'. We appreciate the effective leadership Dr. Canon has accomplished within the Radiology Department.

## Gratitude

We greatly appreciate Dr. Ahmed Kamel's efforts in collaborating and enabling a successful recruitment for Ammar Al-mehmi, MD. Dr. Al-mehmi will join the Division of Nephrology as an Associate Professor of Medicine and as Director for Interventional Nephrology effective December 1, 2015.

## Chief Quality Resident Program (CQRP)

Congratulations to Ryan Telford, MD for being chosen as one of seven new Chief Quality Residents in UAB Medicine's newly developed CQRP! CQRP started last year to allow additional engagement opportunities regarding concepts in quality and patient safety for interested fellows and residents. We are proud to have Dr. Telford represent the Department of Radiology in this new journey.

## Resident Lounge Progress

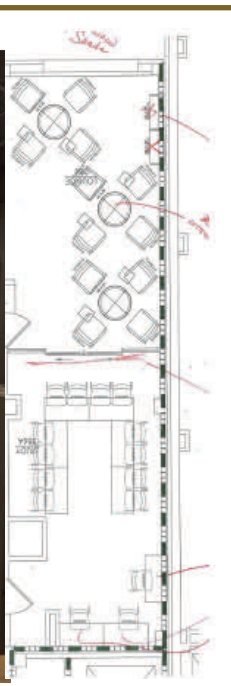

## RSNA BROCHURE

**DAILY SCHEDULE**  
Sunday, November 29

**CASE OF THE DAY**  
ED013 SU—Location: Case of the Day, Learning Center. Physical Case of the Day. David Gamett PhD.

**POSTER SESSIONS**  
RC2008—Location: E4508—8:30-10:00 am. Mixed diagnoses in the head and neck. Philip Chapman MD.

**POSTER SESSIONS**  
SSA010—Location: E351A—10:45 am-12:15 pm. Gastro-intestinal (Pancreas solid masses). Michael Blake MBBCh, Debra Morgan MD.

**POSTER SESSIONS**  
SSA10 05—Location: E351B—10:45 am-12:15 pm. Characterization of Adrenal Lesions using rapid Ultravol switching dual energy CT. Utility of contrast-enhanced material suppression imaging. Jason Pieterse MD, Mark Lockhart MD, Theresa Weber MD, Lincoln Berkland MD, Bradford Jackson, Debra Morgan MD.

**POSTER SESSIONS**  
CHS 50A—Location: CH Community, Learning Center—12:30-1:00 pm. Case: Subdural Hematoma. Sonawane MD.

**CHS 50B—Location: CH Community, Learning Center—1:00-1:30 pm. Case: Subdural Hematoma. Sonawane MD.**

**INTERVENTIONAL SESSION**  
RC101—Location: N22E—2:00-3:00 pm. Read with the experts (Cardiac Radiology). Frank Rydzicki III MD, PhD, Sander Singh MD, Sangneer Bhalla MD, Jacobo Kirsch MD.

**CASE OF THE DAY**  
ED013 MO—Location: Case of the Day, Learning Center. Physical Case of the day. David Gamett PhD.

**POSTER SESSIONS**  
RC2008—Location: E4508—8:30-10:00 am. Mixed diagnoses in the head and neck. Philip Chapman MD.

**POSTER SESSIONS**  
VI120 ED MOA6—Location: VI Community, Learning Center—12:15-12:45 pm. Minimally invasive treatment options for management of Angiomyolipoma. Amir Moustafa MBBCh, MSc, Ahmed Kamel Abdel Aal MD, PhD, Jonathan Humberston MD, William Barrett MD, Nathan Erel MD, Rachel Ovar MD.

**EDUCATION EXHIBITS**  
Sunday—11:00 am—5:00 pm  
Monday—Wednesday—10:00 am—5:00 pm  
Thursday—10:00 am—2:00 pm

**ED020—ED—N GI Community, Learning Center—Tissue and Vessel Characterization of the Pancreas. Steve Gervais, Thomas W. Ng MD, Marka Ojaghar MD, Aron Sakhar MD, Cheri Canon MD, Louise Alexander MD.**

**GI177—ED—N GI Community, Learning Center—Catch us if you can! Early detection of Pancreatic Adenocarcinoma. Prashant Chatterjee, Lindsay MD, Sharon Adams MD, John Sanders MD, Caroline Parada MD, Henry Alameddine MD, Wallace Morgan MD, Rajesh Karam MD, Frank Heller MD.**

**INSTRUMENTATION**  
INSTRUMENTATION—Phytophysical Diagnostics—Evaluation of Barium Swallow. Stephanie Angel MD, Jason Prater MD, Bruce Koval MD, Jessica Zaroske MD.

**CHESIT**  
CHESIT—ED—N GI Community, Learning Center—Hidden in Plain Sight: How contrast flow systems on Thoracic CTA can reveal more about your new Dual-Source MD. Katherine Kap, Paul Soehnle MD, PhD, Dana Ovar MD, Abhaak Chatterjee MD, Albertina M. Community, Learning Center—Pulmonary Imaging of Pulmonary Artery Aneurysms: An Exhibit on the Radio. 40. Role of Endovascular and Percutaneous Catheter Lines. Shrawa Kowak MD, Lawrence Swartz MD, Rabih Seifan MD, Karthik Chhabr MD, Rajal Sonawane MD.

**INTERVENTIONAL**  
VI113—ED—N VI Community, Learning Center—Stentriac Access: Hemodynamic Endovascular management and outcomes. Ahmed Kamel Abdel Aal MD, Amir Moustafa MBBCh, MSc, Rachel Ovar MD, Nathan Erel MD.

**VI112—ED—N VI Community, Learning Center—Peritoneal Dialysis catheter placement techniques using Fluorography and Ultrasound guidance. Ahmed Kamel Abdel Aal MD, PhD, Amir Moustafa MBBCh, MSc, Nathan Erel MD, Rachel Ovar MD.**

**VI123—ED—N VI Community, Learning Center—Endovascular management of bleeding neck aneurysms. Ahmed Kamel Abdel Aal MD, PhD, Amir Moustafa MBBCh, MSc, Rattia Darwish MBBCh, Maysoon Issaid MD, MSc, Osama Aglan.**

**VI122—ED—N VI Community, Learning Center—Techniques for Transcatheter Closure of Patent Foramen Ovale. Gaurav Anand, Kamel Abdel Aal MD, PhD, Rachel Ovar MD, Sina Barakat MD.**

**VI187—ED—N VI Community, Learning Center—Endovascular management of Peroneal Pulmonary Arteriovenous Malformation. Ahmed Kamel Abdel Aal MD, PhD, Amir Moustafa MBBCh, MSc, Hassan Hamed MD, MSc, Nathan Anany MD, Sami Abdou MD.**

**RSNA 2015** INNOVATION IN THE FUTURE

101st Scientific Assembly & Annual Meeting

**A NEW CENTURY BEGINS**

November 29th - December 4th

McCormick Place  
Chicago, IL

**BARFIELD-CARTER LECTURE—January 21, 2016**  
**GERALDINE McGINTY, MD**  
Assistant Professor of Clinical Radiology  
Weill Cornell Medical College, Cornell University

## A GLOBAL KNOWLEDGE LEADER

The Center for World University Rankings releases an annual list of the top 1,000 institutions around the globe. According to its 2015 rankings, UAB is in the top 15 percent of universities worldwide.



### TOP 150 WORLDWIDE IN FOUR CATEGORIES:



**UAB THE UNIVERSITY OF ALABAMA AT BIRMINGHAM**  
Knowledge that will change your world.

**Dr. Cheri Canon invites you and a guest to the**

**UAB Department of Radiology**

**Reception**

**UAB SCHOOL OF MEDICINE**  
Department of Radiology

**during the 2015 RSNA Annual Meeting**

**Monday, November 30 | 7:00 p.m.**

**Osteria Via Stato**  
620 North State Street  
Chicago, Illinois 60654

Please RSVP to alexandragross@uabmc.edu by November 23

## FUNDS

**Our Goal:** Over the next five years, we hope to raise \$500,000. Please read about our leadership and education funds and consider contributing.

The **Robert J. Stanley, M.D. Leadership Fund** is appropriately named in honor of Dr. Stanley's many decades of leadership. We have begun incorporating a Business & Leadership Conference curriculum for our residents, designed to provide additional opportunities for in depth leadership training. As healthcare is undergoing monumental changes, we must invest in the training of our future leaders in order for the specialty of Radiology to remain viable. Therefore, funds received will provide opportunities for leadership development for trainees and faculty.

The **Robert E. Koehler, M.D. Education Fund** is named in honor of Dr. Koehler's lifelong educational accomplishments. The first project will be a new learning laboratory for our trainees. The need to expand our curricular offerings is vital in preparing our residents to be well-rounded radiologists for the future.

## To Give A Gift:

By mailing a check made payable to the "UAB Department of Radiology" to the following address:

619 19th Street South  
JT N451  
Birmingham, AL 35294-0017

Or, you may give a gift online by clicking the fund of your choice:

- [Stanley Fund for Leadership](#)
- [Koehler Fund for Education](#)

*Created By: L. Newell*